

DeckWise® International BV • Nijverheidsweg Noord 60-2 • 3812 PM Amersfoort • Nederland
• +31 33 4691037 • info@DeckWise.eu • www.DeckWise.eu



STEP 1 - Installing the First Deck Board

Apply Bituminous strip or tape (if available) or a bead of exterior adhesive to your sleeper joists roughly 9,5mm in width. For adhesives, you may want to do this as you go so. This will help prevent the adhesive from drying too quickly. It is important to note that adhesive does increase hold-down strength, but will not stop timber rot. Bituminous strips or tape helps stop joist timber rot and also acts as a seal around fixing screws. Although joists may appear level, fluctuations in weather can trigger plank movement. Both Bituminous strips or tape and/or adhesive will additionally aid the prevention of squeaking from uneven joists in the future.



STEP 2 - Drill a 3,2mm Pilot Hole

Use a 3,2mm drill bit to pre-drill a screw pilot hole for driving the initial screws. Make sure to drill deep enough to penetrate the plank but NOT the joist underneath. We suggest using the 3-in-1 Drill & Drive™ Drill Bit Set, which has a 3,2mm drill bit, 9,5mm countersink bit, and screw gun T15 Star tip that will assist in speeding up this procedure.



STEP 3 - Drill a 9,5mm Countersink Hole Approximately 9,5mm Deep

Utilize a 9,5mm countersink bit to drill a hole roughly 6,4mm to 9,5mm deep (depending on your plank thickness) for every screw to be concealed by a hardwood plug. Be certain your countersink bit is sharp and cuts a clean edge.

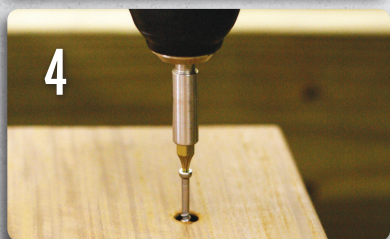

STEP 4 - Drive a Deck Screw Through the Countersunk Hole

Next, firmly drive a terrace screw into countersunk hole and into the sleeper joist beneath. Hardwood Plugs will next be fitted into the countersunk holes to hide the screws and create a family safe surface, free of dangerous screw heads.

HARDWOOD PLUGS
Smooth
3/8" (9,5mm)



EXTREME PLUGS™
Ribbed
3/8" • 10mm • 12mm





5



6



7



8

STEP 5 - Apply Glue Inside

Countersunk Hole (POLYURETHANE BASED RECOMMENDED)

Place a dab of wood glue (polyurethane based recommended) into the countersink hole from the above steps. This will secure the wood plug from popping up in the future. Plus, it will act as a moisture barrier, sealing the countersunk hole and screw.

STEP 6 - Insert a Tapered (Smooth) (or Extreme Ribbed) Wood Plug Into Countersunk Hole

Insert a 9,5mm tapered Hardwood Plug and knock it down using a hammer (so it fits tight within the hole). Be sure to wipe away and remove any excess glue that may be forced out. NOTE: To conceal the plug as much as possible, we recommend aligning the timber fiber grain of the plug with the plank fiber grain.

STEP 7 - Hammer and Flush Cut the Plug

After the plug is hammered in place and the glue has dried, cut off any excess timber material above the plank surface. You may achieve this by utilizing a flush cut pull saw, belt sander or an orbital sander with 80 or 120 grit sandpaper.

STEP 8 - Sand and Prep for Hardwood Oil Finish

Sand smooth all areas where a plug was installed so that plug is flush with deck surface. A round, random orbit sander with 80-120 grit sand paper works best. When sanding is finished, we suggest using a hardwood deck oil for a beautiful natural wood color on your entire deck.

Tools Needed

ELECTRIC SCREW GUN

Used to drill pilot holes and for installing the stainless steel screws.

CAULK GUN & EXTERIOR CONSTRUCTION ADHESIVE

Used as a leveling agent for uneven joists.

BITUMINOUS TAPE

Used to prevent joist wood rot as well as seals around deck screws.

WOOD GLUE

Polyurethane based recommended.

HAMMER

Used to tap plug into countersunk hole.

FLUSH CUT PULL SAW, BELT SANDER OR AN ORBITAL SANDER

A round, random orbit sander with 80-120 grit sand paper works best.



(We suggest using the DeckWise® Drill & Drive™ (included in Master Plug Kit), which is a 3-in-1 drill bit, countersink bit, and screwgun T15 tip that will help speed up this process.)